

Box Contents



POS	QTY	Item Description
1	1	Base with rollers
2	1	Pole
3	1	M10 screw
4	1	M10 flat washer
5	1	M10 lock washer
6	3	Adapter plate thumbscrews
7	1	Basket
8	1	Handle
9	2	M5 socket head screws
10	2	Semi-detached plastic clamp parts
11	2	M6 socket head screws
12	1	Reference card set attached to basket
13	2	M6 nuts
14	1	M8 socket head screw
15	1	Adapter plate
16	3	Hex keys
17	1	Power supply holder
18	1	Toothed disk

1. Remove the rubber washer, if present, from the base (1) & discard.

2. Insert the toothed disk (18) into the top of the base.



3. Insert the pole (2) in base (1), on the top of the toothed disk.



4. Set pole & base on its side.

5. Place M10 lock washer (5) & M10 flat washer (4) on M10 socket head screw (3) & thread into base.

6. Tighten the M10 socket head screw with the appropriate hex key until the locking washer is flattened against the flat washer. Tighten securely.



7. Return pole stand to its upright position.

8. Mount the basket (7) directly under the locking knob on the outer tube using M6 socket head screws (11) and plastic clamp parts (10). The flat plastic clamp without the SunTech logo must mount to the basket.

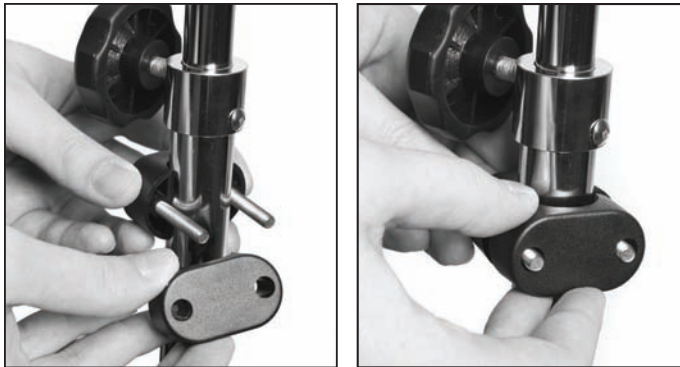

Position M6 nuts (13) in slot & tighten screw securely using appropriate hex key.

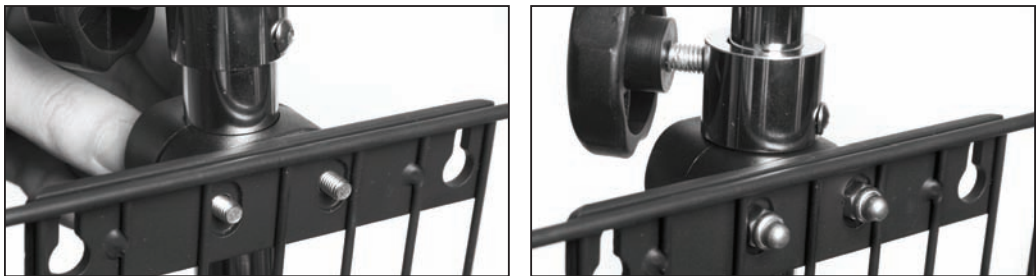

9. Secure the handle (8) to the basket (7) using M5 screws (9) and the appropriate hex key. Tighten securely.

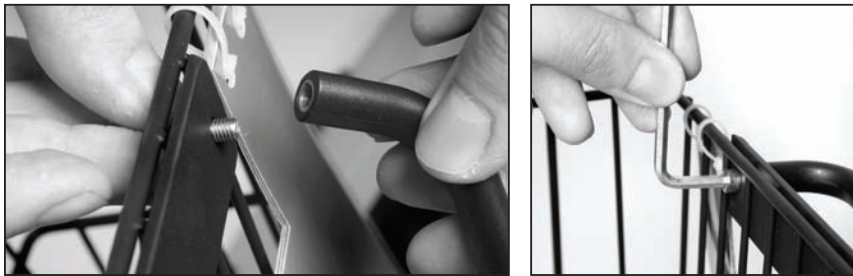

10. Ensure that the pole's locking knob is securely tightened to prevent the pole from rotating when tightening the screw. Secure the adapter plate (15) and power supply holder (17) onto the pole using M8 socket head screw (14) and appropriate hex key.

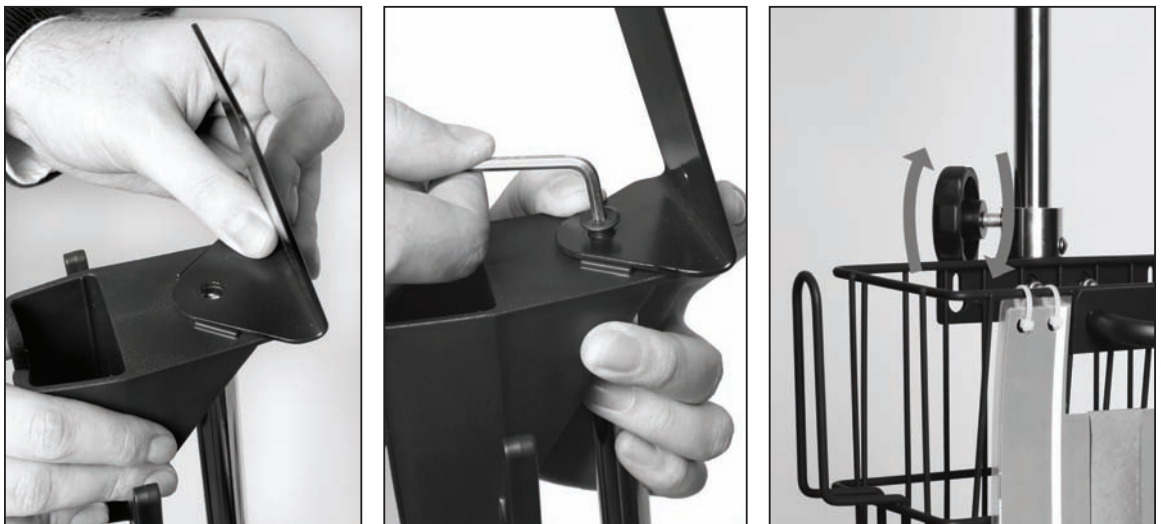

11. The SunTech 247 Diagnostic Station is to be fixed on the adapter plate using the three thumb screws (6). For more detailed instructions, see the supplied Quickstart Guide, Instruction 1c.

12. To adjust the height of the pole, rotate the locking knob counterclockwise, adjust to the required height and then rotate the locking knob clockwise to tighten.